



£675 pcm

Tamworth Road, Two Gates, B77 1EG



- PETS ACCEPTED
- 2 Bedroom Mid Terrace
- Gas Central Heating
- Double Glazing
- Lounge and Separate Dining Room
- Kitchen with Integrated Appliances
- Large 4 Piece Bathroom
- Good Size Rear Garden
- Close to Town Centre
- Available Early August

To Let With Next Place Property Agents ++ PETS ACCEPTED ++ Traditional Mid Terrace Property ++ Lounge ++ Separate Dining Room ++ Fitted Kitchen with Integrated Appliances ++ Pantry ++ 2 Double Bedrooms ++ Large 4 Piece First Floor Bathroom ++ Good Size Rear Garden ++ Double Glazing ++ Central Heating ++ Available Early August ++

NEXT PLACE PROPERTY AGENTS LIMITED

01827 50700 www.next-place.co.uk 112 Glascote Road, Tamworth, B77 2AF

Registered Office. 3Mc Middlemarch Business Park, Siskin Drive, Coventry CV3 4FJ Company Reg No. 08878421



GROUND FLOOR

Lounge 3.80m (12'6") x 3.38m (11'1") Window to front, radiator, gas fire with wooden surround and marble inset and hearth, door to:

Dining Room 3.88m (12'9") x 3.80m (12'6") Window to rear, radiator, coving to ceiling, door to an under stairs storage cupboard, door to:

Hallway Tiled flooring, stairs to first floor landing, door to the rear garden, open plan to:

Kitchen 2.72m (8'11") x 2.12m (6'11") Fitted with a matching range of base and eye level units with worktop space over, 1+1/2 bowl sink with single drainer and mixer tap, integrated fridge, freezer and washing machine, gas and electric points for cooker, window to side, tiled flooring, door to:

Pantry Wall mounted boiler, window to side.

FIRST FLOOR

Landing Radiator, all doors lead off.

Bedroom 1 3.80m (12'6") x 3.38m (11'1") Window to front, radiator.

Bedroom 2 3.84m (12'7") x 2.97m (9'9") max Window to rear, radiator.

Bathroom Fitted with a four piece suite comprising deep panelled bath with telephone style mixer tap and hand shower attachment, inset wash hand basin in vanity unit with storage under, WC with hidden cistern, tiled shower enclosure, window to rear, heated towel rail.

OUTSIDE The property is set back from the pavement behind a dwarf wall. The rear garden is of a good size and is mainly laid to lawn with a good size patio area to the rear.

To apply for this property, a refundable holding deposit equivalent to 1 weeks rent is payable. Council Tax is Band A

Ground Floor

Approx. 39.0 sq. metres (419.5 sq. feet)

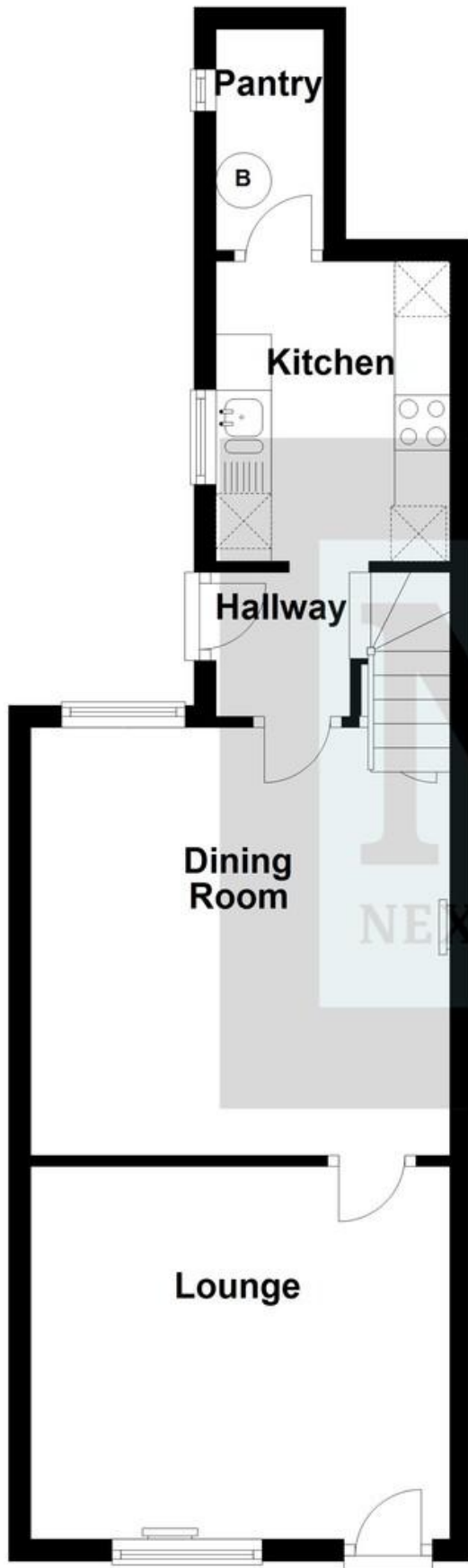

First Floor

Approx. 36.8 sq. metres (396.6 sq. feet)

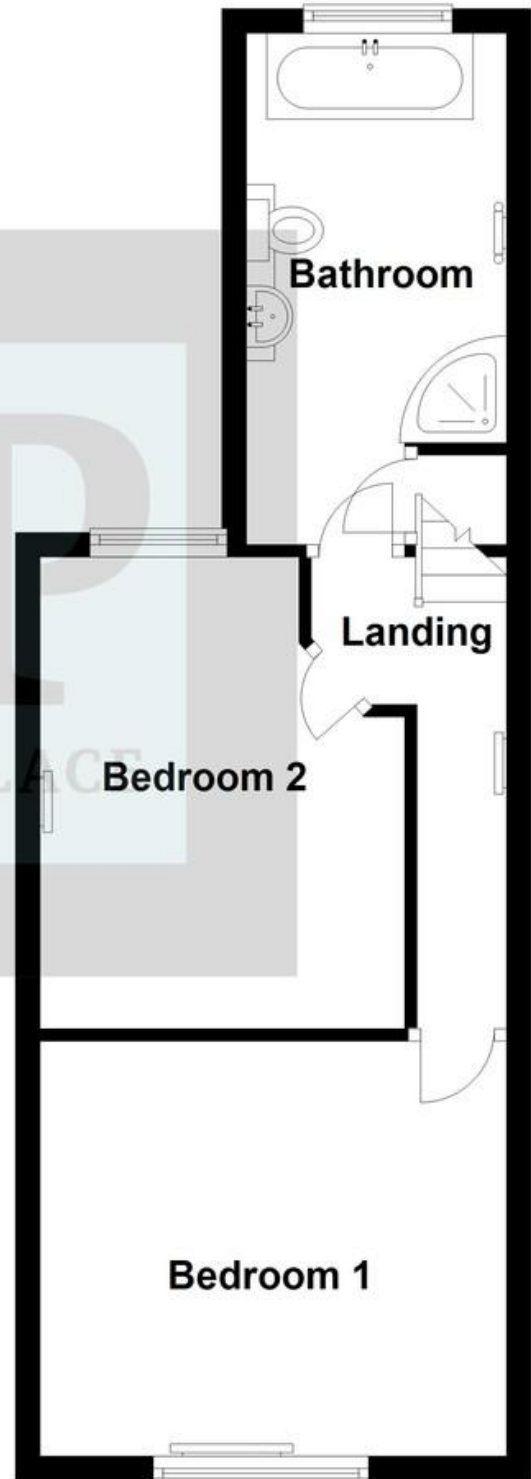

Total area: approx. 75.8 sq. metres (816.1 sq. feet)

£675 pcm

Tamworth Road, Two Gates, B77 1EG

